

Missouri Pacific 1927 Standard Tool House Kit 1005



A Brief History

The in 1927 the Missouri Pacific made changes in their standard design for portable tool houses. The major difference was to add a small double window in the end of the building that the door was located. This was actually a return to an earlier feature that had been deleted when the road change the siding used on these buildings from board and batten to a horizontal siding.

Construction

Construction of this kit is straight forward and should not more than one or two evening to complete. Read the directions and take your time.

Tools:

Only a few tools are required.

- A small square will be helpful in holding corners at 90° while the glue dries.

- Modelers knife with several No. 11 blades
- Your choice of glue - Carpenters and/or CA glues are recommended
- Paint and brushes or an air brush
- A straight edge such as a scale ruler will be handy also

Painting:

I recommend that you pre-paint all parts before assembly as much as possible. I personally like to use Dupli-color automotive primer to both fill some of the wood grain and to give an even color to the basswood and plywood parts. If brush painting, paint both sides to reduce any tendency to warp.

Caution:

Always be careful handling sharp tools and CA type glues. Keep tools and small parts away from small children.

Parts layout

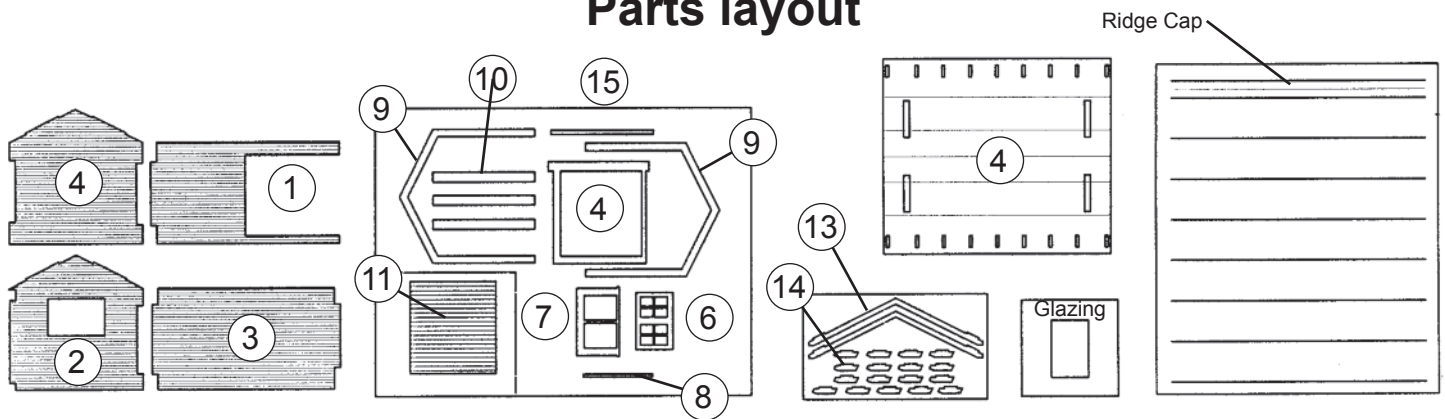

Lake Junction Models, LLC

PO Box 440368 Brentwood, MO 63144

email: lakejctmodels@att.net On the Web at: lakejunctionmodels.com

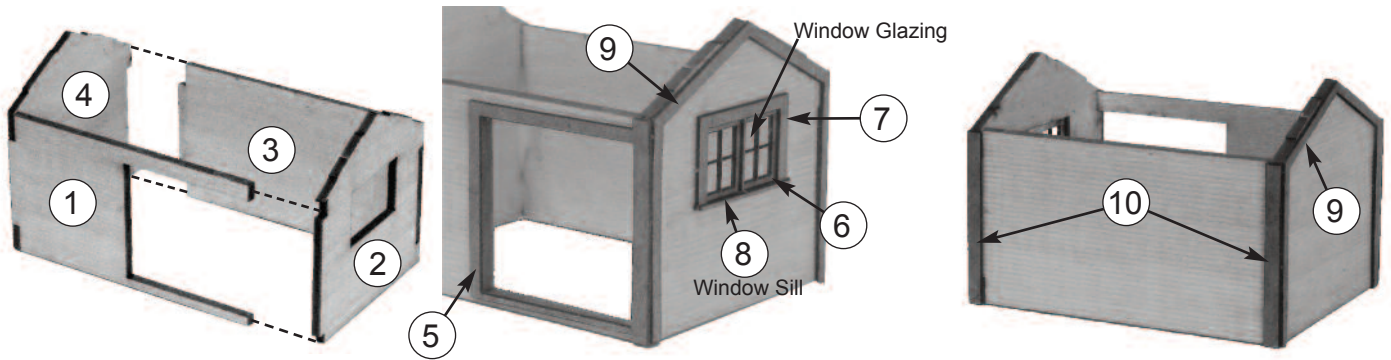

1. Glue walls 1 thru 4 together, being sure to keep the corners square.

2. When dry, remove the backing from door trim 5 and keeping all four interior edges flush, press into place.

3. Remove the backing paper from the window sash and press the glazing in place.

4. Next add the window frame 6. There should be an equal amount of sash exposed on the top and two sides.

5. Add the end trim 9 and then the three pieces of side corner trim 10. The outside edges of parts 10 should be flush with the outside edges of parts 9.

6. Glue the door 11 in next from the back.

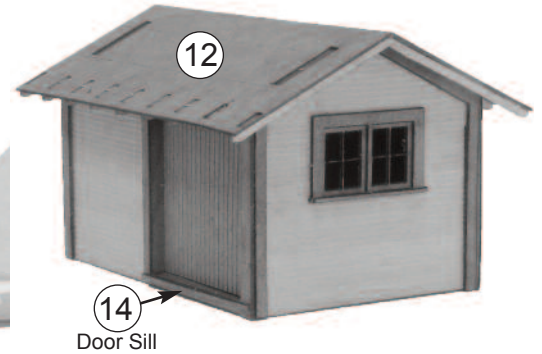
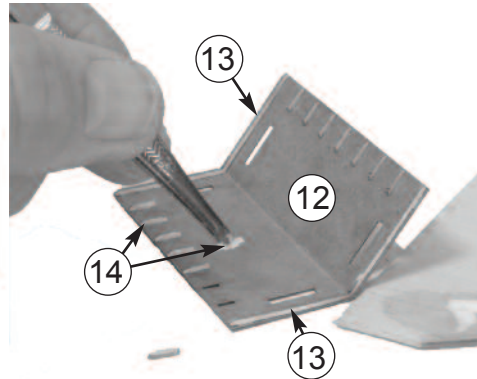
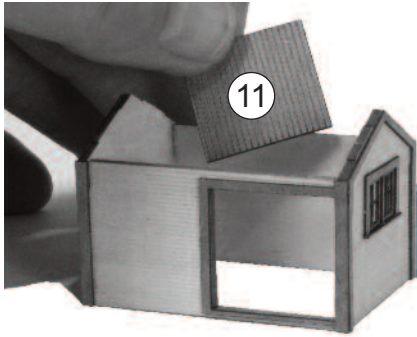

7. Fold the roof about 30 degrees and glue the verge boards 13 in place on each end.

8. The rafters are added next as shown in the photo above.

9. Install the roof in place and glue. Remove backing paper and add the door Sill.

10. Apply roofing as show at left and lower left.

11. Paint in your roads standard structure colors. This model was painted in Missouri Pacific Colonial Yellow and Brown.



PAINTING

Missouri Pacific standard painting called for the use of Colonial Yellow for the body color and Brown for the Trim.

After the Mid 1950's building began to be painted all white.

